



**Online Request for Tender (E-NIT)
for**

**Development of new premises of Branch Panipat, Haryana by way of
Civil-interior, furniture, electrical and allied works.**

**Tender is open only for J&K Bank's empanelled composite
Contractors.**

**e-NIT Ref. No: JKB/E&ED/Panipat(Comp)/2025-1419
Dated: 31-05-2025**

Issued by:
J&K Bank Ltd.
Estates & Engineering Department,
Corporate Headquarters, Srinagar,
M. A. Road Srinagar, 190 001 J&K Tele: 0194- 2402665
email: engineering.chq@jkbmail.com

DISCLAIMER

The information contained in this Tender document or any information provided subsequently to bidder(s) whether verbally or in documentary form by or on behalf of the Bank is provided to the bidder(s) on the terms and conditions set out in this Tender document and all other terms and conditions subject to which such information is provided. This tender is neither an agreement nor an offer and is only an invitation by Bank to the interested parties for submission of bids. The purpose of this tender is to provide the bidder(s) with information to assist the formulation of their proposals. While effort has been made to include all information and requirements of the Bank with respect to the solution requested, this tender does not claim to include all the information each bidder may require. Each bidder should conduct its own investigation and analysis and should check the accuracy, reliability and completeness of the information in this tender and wherever necessary obtain independent advice. The Bank makes no representation or warranty and shall incur no liability under any law, statute, rules or regulations as to the accuracy, reliability or completeness of this e-NIT. The Bank may in its absolute discretion, but without being under any obligation to do so, update, amend, supplement or annul the information in this e-NIT.

OBJECTIVE OF PROPOSAL

The Tender Details are as under:

e-NIT Reference Number	JKB/E&ED/Panipat(Comp)/2025-1419 Dated: 31-05-2025
Issuing Department Name	Estates & Engineering Department, Corporate Headquarters, M.A.Road, Srinagar 190001 J&K
Scope of Work	Civil-interior, furniture, electrical and allied works.
e-Tender Details	Development of new premises of Branch Panipat, Haryana by way of Civil-interior, furniture, electrical and allied works.
BIDs Submission Mode	On-Line through Bank's e-Tendering Service Provider's Portal https://jkbank.abcprocure.com
Tender Type	Limited between Empanelled Contractors
Category	Category C and higher of composite agencies
Type of Contract	Works
Bidding Type	Indigenous
Base Currency	INR (₹)
Validity of Rates	6 Months
Consortium	Consortium Bids are not allowed.
Contact details of concerned Department (Name, Designation, Mobile No., Email address for sending any kind of correspondence regarding this NIT)	1.Mr. Inam ul Haq Keen (I/C Engineering Dept) CHQ Cell no. 9797795973 2.Mr. Saurav Singh Bandral (Assistant Manager) Cell No.9906001286 3.Mr. Nisar-Ul-Nabi (Draftsman) Cell No.9419027096 4.Mr. Mujeeb Manzoor (Manager) Cell No.9906001286 Dept. e-mail id:- engineering.chq@jkbmail.com
Bid Document Availability including changes/amendments, if any to be issued	NIT can be downloaded from and submitted on Bank's e- Tendering Services Provider's Portal http://jkbank.abcprocure.com from June 04, 2025, 16.00 Hrs. to June 16, 2025 15.00 Hrs.
Pre-bid Queries submission Date and Mode	All Clarifications / Queries shall be raised online only through e- Tendering Portal http://jkbank.abcprocure.com by or before June 09, 2025 17.00 Hrs.

Clarifications to pre-bid queries will be provided by the Bank.	All communications regarding points / queries requiring clarifications shall be given online through prescribed e-Tendering Portal on June 12, 2025.										
Last date and time for Bid submission	June 16, 2025, 15.00 Hrs.										
Date and Time for Eligibility/ Technical Bid Opening	To be notified separately										
Submission of online Technical Bid	As prescribed in Bank's online e-Tender Portal https://jkbank.abcprocure.com										
Tender Processing Fee (Non-Refundable)	Not Applicable										
Earnest Money Deposit (EMD) [Refundable]	No EMD is to be Deposited. However, a security deposit of 2% lowest bid amount is to be submitted by the successful bidder in the shape of CDR before a formal allotment is issued in his favour.										
Eligibility & Technical Criteria	Category C and Higher of composite agencies.										
CORRIGENDUM	All the Corrigendum will be uploaded on online tender portal https://jkbank.abcprocure.com only										
For e-Tender related Queries	<p>Service Provider: M/s. E-procurement Technologies Limited (Auction Tiger) , B-705, Wall Street- II, Opp. Orient Club, Ellis Bridge, Near Gujarat College, Ahmedabad- 380006, Gujarat</p> <p>Help Desk:</p> <table border="1"> <thead> <tr> <th>Sr. No</th><th>Name</th></tr> </thead> <tbody> <tr> <td>1</td><td>Sandhya Vekariya - 6352631968</td></tr> <tr> <td>2</td><td>Suraj Gupta - 6352632310</td></tr> <tr> <td>3</td><td>Ijlalaehmad Pathan - 6352631902</td></tr> <tr> <td>4</td><td>Imran Sodagar - 9328931942</td></tr> </tbody> </table>	Sr. No	Name	1	Sandhya Vekariya - 6352631968	2	Suraj Gupta - 6352632310	3	Ijlalaehmad Pathan - 6352631902	4	Imran Sodagar - 9328931942
Sr. No	Name										
1	Sandhya Vekariya - 6352631968										
2	Suraj Gupta - 6352632310										
3	Ijlalaehmad Pathan - 6352631902										
4	Imran Sodagar - 9328931942										

INDEX

S.NO.	DESCRIPTION	Page No
1	NOTICE INVITING TENDER	6-9
2	INSTRUCTIONS FOR BIDDER	10
3	APPENDIX TO FORM OF TENDER	11
4	FORM OF AGREEMENT	12-14
5	GENERAL CONDITION OF CONTRACT	15-21
6	SPECIAL CONDITION OF CONTRACT	22
7	ANNEXURES for Specifications, BOQ-cum-Commercial / Price BID Formats,	23 onwards

(I) NOTICE INVITING TENDER

Tenders are hereby invited by Assistant General Manager (BSD) on behalf of Jammu & Kashmir Bank LTD. Srinagar, J&K for the project:

Development of new premises of Branch Panipat, Haryana by way of Civil-interior, furniture, electrical and allied works.

The Bidder should be an Empanelled Contractor with the J & K Bank in the relevant trade and category as prescribed for the work.

1. Estimated Cost of Work: **Approximately Rs. 29.70 Lakhs**
2. Detailed tender document consisting of Terms and Conditions, BOQ, Technical Specification, General Terms and Conditions etc. will be available through a link from the Banks website www.jkbank.com and will be forwarded to <https://jkbank.abcpocure.com>
3. The site for the work is available and should be inspected before quoting for this tender.

The time allowed for the carrying out of the work will be 60 Calendar days from the date of issue of written orders/ email to commence the work, in a phased manner as decided by the Engineer In charge, J&K Bank Ltd., Srinagar.
4. The Bidders should digitally sign the tender in places indicated and the total amount tendered should also be written in the prescribed form.
5. The bid document is available online on the website <https://jkbank.abcpocure.com>. The bid document can be downloaded free of cost, however, the successful bidder is required to submit a security deposit of specified amount in the shape of CDR at the time of formal allotment which will be valid till the validity of current empanelment or end of defect liability period whichever is later. The bidder would be required to register in the web site, which is free of cost. For submission of bids, the bidder is required to have valid Digital Signature Certificate (DSC) from one of the authorized Certifying Authorities (CA). Before the deadline for submission of bids, the J&K Bank may modify the bidding documents by issuing online corrigendum. The corrigendum will appear on the web page of the website <https://jkbank.abcpocure.com> under the "Latest Corrigendum".
6. Documents Comprising the Bid.
Only the price bid is to be uploaded online. No other document is to be submitted at the time of Online bid.

A) Deadline for Submission of Bids

- Only Price Bid is to be uploaded by the Bidder online not later than the date and time indicated in the Appendix.
- To give prospective bidders reasonable time in which to take an addendum into account in preparing their bids, the J&K Bank shall extend, as necessary, the deadline for submission of bids. The J&K Bank may extend the deadline for submission of bids by issuing an amendment. In such case all rights and obligations of the J&K Bank and the bidders previously subject to the original deadline will then be subject to the new deadline.

B) Bid Opening & Evaluation

Bid Opening

- The J&K Bank inviting the bids or its authorized representative will open the bids online and this could be viewed by the bidders online.

C) Award of Contract**Award Criteria**

The Bank (J&K Bank) will award the Contract to the Bidder whose Bid has been determined:

(i) To be substantially responsive to the bidding documents and who has offered the lowest evaluated Bid price, provided that such Bidder has been determined to be :-

- a) Eligible in accordance with the provisions, and
- b) Qualified in accordance with the provisions; and

(ii) To be within the available bid capacity adjusted to account for his bid price which is evaluated the lowest.

J & K Bank reserves the right to accept or reject any Bid, and to cancel the bidding process and reject all bids, at any time prior to the award of Contract, without thereby incurring any liability to the affected Bidder or bidders or any obligation to inform the affected Bidder or bidders of the grounds for the Bank's action.

7. The Bidder whose tender is accepted shall execute an Agreement on Rs. 100/- stamp paper reiterating the acceptance of his Execution of work on these item rates and conditions as set forth in the contract.
8. J&K Bank Ltd. reserves the right to reject any or all the tenders without assigning any reason thereof.
9. Taxes which are admissible for deduction shall be deducted at source at the rates admissible at the time of payment of the bill of contractors.
10. The right of acceptance of a tender will rest with the Assistant General Manager **BSD, J&K Bank Ltd., CHQ, Srinagar** who does not bind himself to accept the lowest tender and reserves with himself the authority to reject any or all the tenders received, without assigning any reason. Any tenders in whom any of the prescribed conditions are not fulfilled or are incomplete in any respect, are liable to be rejected.
11. Canvassing in connection with tender is strictly prohibited and the tender submitted by a Bidder, who resorts to canvassing, is liable to be rejected.
13. On acceptance of the tender, the name of the accredited representative(s) of the Bidder who would be responsible for taking instructions from the Engineer In Charge shall be communicated to the **Engineer In charge, J&K Bank Ltd., Srinagar**.
14. Special care should be taken to write the rates in figures.
15. The bidder has to bid for all works contained item wise in the BOQ. The Bank has reserved right to accept the whole or any part of the tender and the bidder shall be bound to perform the same at the rate quoted.
16. The Bidder at the end shall add Goods & Service Tax separately which as per the government notification shall be payable at the time of payment with respect to the prevailing government rates at that time. The individual rates filled in the Tender shall be exclusive of GST but inclusive of all material plus labour, delivery, transportation, handling, wastage, levies and the such and

include ALL costs/overheads to be incurred by the Bidder for executing these works as per the drawings, details, specifications, with the care, expertise and post execution responsibilities outlined in this Tender. No additional claim over the rates shall be entertained later.

- 17 The Tender for the work includes the Composite works as per BOQs, drawings and directions of the Engineer In charge.
- 18 The Bidder shall inspect the site before submitting the tender.
- 19 The intending Bidder should not in any way quote more than one rate per item of work. In case the Bidder splits the quantity of any item of work and quotes more than one rate for the same, his tender will be rejected. The Bidders shall quote in figures as well as in words, the rates, & the amount tendered by them. The amount for each item should be worked out and the requisite totals be given.

Sd/-

Assistant General Manager BSD

ELIGIBILITY CRITERIA AND CREDENTIALS

- The Bidder should be an empanelled Contractor of J & K Bank of **category-C** or higher of composite works.
- The Bidder should have minimum available Bid capacity/Financial Capability as required for the said work.

Should this tender be accepted in whole or in part, I/We hereby agree:

1. To abide by all terms and provisions of the said conditions annexed here to and all the terms and provisions contained in the Notice Inviting Tenders, so far as applicable and / or in default thereof to forfeit & pay to the Bank, by their successors the sum of money mentioned in the said conditions.
2. To execute all the works referred to in the tender documents upon the terms & conditions contained or referred to therein & to carry out such deviations as may be ordered up to a maximum of **50% (fifty percent)** of the tendered value at the rates quoted in the tender documents.

Digital Signature of Contractor before Submission of Tender

Witness

1. _____

2. _____

Sd/-

Assistant General Manager BSD

(II) INSTRUCTIONS FOR BIDDERS

1. Before e-BID, the Bidders, in their interest are advised to inspect and examine the site & its surroundings and satisfy themselves in respect of the site conditions as the Bank shall bear no responsibility for lack of acquaintance of the site and other conditions or any information relating thereto, on their part. The consequences of the lack of knowledge, as aforesaid, on the part of the Bidders shall be at their risk and cost.
2. Before tendering, the Bidders shall carefully examine the tender documents, general conditions of contract, special conditions of contract, specifications, drawings & other matters referred to therein, the schedules and Bill of quantities and if there should be or appear to be any ambiguity in or discrepancy between any of these documents or between figured and measured dimensions and other aspects upon the Drawings, he should immediately refer the matter in writing to the Engineer In charge for clarification.
3. Selection of the items according to specifications and approved makes will be as per the conditions of the contract and as per the drawing attached. All the items before installing should be approved from Engineer.
4. The Bank will not be responsible and will not pay for expenses which may be incurred or losses to person or property suffered by the Bidder in connection with visits to an examination of the site and in the preparation of his tender for submission.
5. The Bidder (whether or not he submits a tender) shall treat the details of the documents as secret and confidential.
6. The Bank reserves the right to adjust arithmetical or other errors in any tender in the way, which it considers suitable. Any adjustments so made by the Bank shall be stated to the Bidder if the Bank shall make an offer to accept the tender.
7. The Bank does not bind itself to accept the lowest or any tender and has the right to refuse or accept any tender without assigning any reason (s) thereof. The Bank shall also have right either to invite more Bidders for submitting tenders or re-issue the Tenders afresh at their own discretion for which the original Bidders shall have no right of objecting any action taken in this behalf by neither the Bank nor the Bank shall be bound to any explanation in this behalf.
8. All documents of the tender are to be read in conjunction with each other and Bidder shall take this aspect into consideration while quoting the rates.
9. It will be the responsibility of the successful Bidder to keep liaison with the Bank till finalization of Letter of Acceptance or within validity period. No excuse whatsoever will be entertained for not having received the allotment letter/Letter of Acceptance through post or otherwise.

(III) APPENDIX TO FORM OF TENDER

S.No	Particulars	Description
1	Earnest Money / Security Deposit:	No EMD for the Work. However, the successful bidder is required to submit a security deposit of 2% of lowest bid received in the shape of CDR at the time of formal allotment which will be valid till the validity of current empanelment or end of defect liability period whichever is later. The security deposit is to be submitted by the firm for the first successful bid only, which shall be valid for subsequent bids for other works also. The total security deposit (retention money + initial security deposit+ EMD) will be kept with the bank ,50% of the total security deposit amount shall be refunded without interest to the contractor on the issuance of virtual completion certificate by the Architect/Bank and the contractors removal of his material ,equipment ,labour force ,temporary sheds stores ,site office etc. and on receipt of physical possession of site by the bank .The remaining 50% of the total security deposit may be refunded 15 days after end of defect liability period provided he has satisfactorily carried out all the works and attended to rectification of all defects in accordance with conditions of the contract.
2	Period of commencement:	Date of issue of letter of acceptance or the date of handing over of site whichever is later.
3	Time of Completion	60 calendar days
4	Reverse Auction	The Tender shall be put to reverse auction after the last date of the submission of bids to get a final successful bidder and work shall be allotted to the lowest bidder after the reverse auction.
5	Liquidated damages for delay:	0.5% (Zero decimal five percent) of Gross Contract value per week or part thereof subject to a maximum 10% of contract value
6	Limit of liquidated damages	Up to a maximum of 10% (Ten percent) of Contract Value.
7	Defects Liability /Maintenance period	12 months from the date of issue of virtual completion certificate as issued by Engineer (As per Procurement Of Works policy Retention Clauses (

		Page no 12 , 13 & 31)
8	Retention Money	From each running bill, an amount at the rate of 10% of the gross value of the running bill shall be recovered as retention money .EMD & ISD shall also form the part of the retention money till deposit of 10% of the total contract value, this amount is called Total Security Deposit which consist of three components, EMD, ISD & RM. The total security deposit will be kept with the bank ,50% of the total security deposit amount shall be refunded without interest to the contractor on the issuance of virtual completion certificate by the Architect/Bank and the contractors removal of his material ,equipment ,labour force ,temporary sheds stores ,site office etc and on receipt of physical possession of site by the bank .The remaining 50% of the total security deposit may be refunded 15 days after end of defect liability period provided he has satisfactorily carried out all the works and attended to rectification of all defects in accordance with conditions of the contract
9	Quantities	Quantities as per BOQ liable to change as per work done at site.
10	Running Payments	Running Payments should be done as per Annexure C
11	Final Payment	Final payment shall be done after completion certificate by the engineer and joint measurements with the contractor, subject to deductions

FORM OF AGREEMENT

(On Stamp Paper 100/=)

ARTICLE OF AGREEMENT made at Srinagar this _____ day of Two Thousand Twenty Five between J.K. BANK, having its Head office at Maulana Azad Road, Srinagar (J&K), through the Assistant General manager (BSD) hereinafter called “Bank” (which expression shall include its successors and assigns wherever the contract meaning shall so require or include its successors & assigns wherever the contract meaning shall so require or permit of the one part and M/s. _____) hereinafter called the “Contractor” of the other part.

WHEREAS the Bank is desirous of having provided and getting executed, completed and maintain certain works for **Development of new premises of Branch Panipat, Haryana by way of Civil-interior, furniture, electrical and allied works.**, enumerated or referred to the Documents forming part of the “TENDER” and acceptance, copies of all of which hereto annexed are designed to form part of this contract and are included in term “CONTRACT” wherever herein used.

AND WHEREAS the Bank accepted the tender of the contractor for the provisions of execution, completion & maintenance of work under defect liability period of the above said work.

AND WHEREAS the individual rates filled in by the CONTRACTOR are exclusive of GST but inclusive of all material plus labour, delivery, transportation, handling, wastage, levies and the such and include ALL costs/overheads to be incurred by the CONTRACTOR for executing these works as per the drawings, details, specifications, of the Engineer with the care, expertise and post execution responsibilities outlined in this Tender. THE CONTRACTOR confirms that no additional claim over the rates shall be entertained later by THE BANK.

AND WHEREAS the contractor has agreed with the Bank to execute complete and maintain during the defect liability period subject to the conditions and instructions set forth herein (hereinafter referred to as “the said conditions”) the works, shown upon the documents forming part of the contract as stated hereinafter, on the item rate basis & as set forth, amounting to the contract sum of Rs. (IN WORDS) (hereinafter referred to as “the said contract amount /Price/Sum”).

NOW THIS AGREEMENT WITNESSETH AS FOLLOWS:

1. The terms and conditions laid down in the documents stated herein in the Clause shall be read and construed as forming part of this Agreement and the contractor shall abide by, terms and conditions, specifications and rates specified therein and perform agreement in accordance with such conditions”.
2. The following documents shall be deemed to form and be ready and construed as part of this agreement:
 - a. The said tender and Appendix
 - b. Form of Tender
 - c. General conditions of Contract
 - d. The Special Conditions of Contract.
 - e. Specifications
 - f. Preamble to bill of quantities and priced bill of quantities as accepted.
 - g. The letter of Acceptance
 - h. Other additional documents as required

3. In consideration of the payment to be made by the Bank to the contractor for the work to be executed by him, the contractor does hereby agree with the Bank to provide, execute & complete the said work on or before the date mentioned in the time schedule of completion of work attached to the tender documents strictly as per the contract agreement and shall maintain the same at his own cost during the defects liability period , thereafter perform all such aspects and things in the contract mentioned or described or which are to be implied thereafter or may be reasonable necessary for the completion of the said works and at the time and the manner subject to the terms and conditions or stipulations mentioned in the contract.

4. In consideration of the due provisions, execution and completion of the said works the Bank does hereby agree with the contractor that the Bank will pay to the contractor the respective amount for the work actually done by him and such other sums as may become payable to the contractor under the contract. Such payment to be made at any such time & in such manner as provided for in the agreement.

5. All disputes arising out of or any way connected with this agreement shall be deemed to have arisen in J & K and only the courts at Srinagar shall have jurisdiction to determine the same.

6. The several parts of this contract have been ready by/to us and fully understood by us.

7. This Agreement shall come into effect on _____ (the effective date). The agreement shall remain in force for a **60 Calendar days from the said effective date till the envisaged timeframe for completion or actual date of completion whichever is later**

8. Bank shall be entitled to terminate this agreement in case of breach of any of the terms and conditions of this agreement and related tender documents after serving a notice of 20 days to the contractor.

9. that upon expiration or termination of this agreement for any reason whatsoever, the contractor shall;
i) Immediately refrain from any action that would cause or may indicate any relationship between it and the bank.

ii) Forthwith hand over to the bank, the possession of all the documents, material or any other property belonging to the bank that may be in its possession.

10. The bank reserve the right to terminate this agreement without assigning any reason thereof.

11. The contractor hereby agrees and undertakes to indemnify the bank and keep it indemnified against any loss or damage suffered by the bank on account of any act or omission on part of the contractor.

12. The provision of this agreement, which are intended to survive the term of this agreement by their very nature, shall survive the termination of this agreement. Notwithstanding, arbitration and applicable law and jurisdiction shall survive the termination/expiration of this agreement.

13. The Security deposit will be forfeited by the bank in case of breach of any of the terms and conditions of this agreement.

14. IN WITNESS WHEREOF, the parties have caused their respective common seals to be here unto affixed (or have here unto set their respective hands and seals) the day and the year first above written:

NAME_____

ON BEHALF OF THE BANK

- 1. SEAL
- 2 ADDRESS

In Presence of:

NAME_____

ON BEHALF OF THE CONTRACTOR

- SEAL
- ADDRESS

(v) GENERAL CONDITIONS OF CONTRACT

1. Extent of Contract

The contract comprises the construction, completion & maintenance of the works & except in so far as the contract otherwise provides, the provision of all labour, materials, constructional plant, temporary works & everything whether of a temporary or permanent nature required in and for such construction, completion & maintenance so far as the necessity for providing the same is specified in or reasonably to be inferred from the contract.

2. Letter of Intent / Acceptance / Award

Before signing of the contract, the Bank may issue by registered post or by otherwise, depositing at the registered office of the contractor, letter of Intent / Acceptance to enter into a contract with the contractor for the execution of the works in accordance with the contract. Upon issue of such Letter of Acceptance / Intent by the Bank, the Bank shall be deemed to have signified his intention to award the contract, however, the process shall be deemed to be complete only when the contract has been entered into by the Bank & the contractor. However, until a formal contract agreement is prepared & executed, the tender together with the Bank's letter of intent shall constitute a binding contract between the parties, provided the Security Deposit as required under the contract shall have been furnished by the contractor

3. Contract Agreement

Within 10 days after the issue of letter of acceptance, the contractor shall have to enter into a written deed of agreement incorporating all the terms & conditions as embodied in the Tender Documents or modified subsequently in writing and those contained in the letter of acceptance, with the Bank. The contractor shall not sub-contract the work without written permission of the Bank.

The following documents shall be deemed to form and be ready and construed as part of the contract agreement.

- a) The said Tender & Appendix
- b) Form of Tender
- c) General Conditions of Contract
- d) Special conditions of Contract
- e) Letter of Acceptance
- f) Contract Price
- g) Priced bill of quantities as accepted.
- h) Specifications
- i) Drawings
- j) Other additional documents as required.

4. Language (s)

The language in which the contract documents shall be drawn up shall be English.

5. Documents Mutually Explanatory

Except if & to the extent otherwise provided by the contract, the provisions of the conditions of contract shall prevail over those of any other document forming part of the contract. Subject to the foregoing, the several documents forming the contract are to be taken as mutually explanatory of one another but in case of ambiguities or discrepancies, the same shall be explained & adjusted by the Site Engineer who shall thereupon issue to the contractor instructions directing in what manner the work is to be carried out.

6. Contractor's General Responsibilities

The contractor shall, subject to the provisions of the contract, and with due care & diligence, execute, complete & maintain the works & provide all labour including Supervision, materials, constructional plant & all other things, whether of a temporary or permanent nature, required in and for such execution, completion & maintenance so far as the necessity for providing the same, excluding those to be provided by the Bank is specified in, or is reasonably to be inferred from the contractor. Temporary electric, water charges & any other extra charges shall be paid by the contractor & nothing shall be paid by the Bank.

The contractor shall carry out and complete and maintain the works in accordance with accepted good engineering practices and using materials and workmanship of the quality and standards therein specified provided that where and to the extent that approval of the quality of materials or of the standards of workmanship is a matter of option, such quality & standards shall be to the satisfaction of the Bank or Engineer in Charge or his Representative.

7. Safety of Site Operations

The contractor shall take full responsibility for the safety, stability and adequacy of all site operations and methods of construction including all temporary works, provided that the contractor shall not be responsible, except as may be expressly provided in the contract, for the design or specification of the permanent works.

8. Absence of Specification

If the specifications do not contain particulars of materials and works which are obviously necessary for the proper completion of the works, and the intention to include, which is inferred, all such materials and works shall be supplied and executed by the contractor without extra charge. If the contractor requires additional information, he shall, so request in writing, well in advance to commencement of the particular work, to the Engineer Incharge who will issue such detailed information as necessary within a reasonable time.

If, however, during the execution of the works, the contractor shall encounter physical conditions or obstructions constituting Force Majeure and which could not have been reasonably foreseen by an experienced contractor, the contractor shall forthwith give written notice thereof to the Engineer In Charge / Engineer's representative within two weeks after its occurrence and if in the opinion of the Engineer In Charge, such conditions or obstructions until so instructed by the Engineer In Charge except in the event of there being an urgent need to undertake remedial or other works or repairs to reduce risks of injuries or damages to persons or property.

9. Obtaining Information related to execution of work

No claim by the contractor for additional payment will be entertained which is consequent upon failure on his part to obtain correct information as to any matter affecting the execution of the works nor will any misunderstandings or the obtaining of incorrect information or the failure to obtain correct information relieve him from any risks or from the entire responsibility for the fulfillment of the contract.

10. Work to be to the satisfaction of Bank

The contractor shall execute, complete and maintain the works in strict accordance with the contract to the satisfaction of the Bank & shall comply with and adhere strictly to the Engineer's instructions and directions on any matter (whether mentioned in the contract or not) touching or concerning the works. The contractor shall take instructions and directions only from the

Engineer. All execution of works & materials should be as per tender specifications. Materials for which specification is not given in tender in that case prior approval from the bank. Contractor is strictly advised not to use substandard materials. And if any substandard material is used or found then a penalty of two times the difference in cost of standard material less substandard material must be collected from the vendor/ sub-contractor. i.e.; $\text{Penalty} = 2 \times (\text{Cost of Standard Material} - \text{Cost of Sub Standard Material})$ or bank have the right to hold the cost of that particular item and entire amount of the project will not be paid.

11. Night or Sunday Work

As the site is in a crowded market, keeping in view the sensitivity of the site, the contractor can be asked to do the work at night, by special order, the contractor would be required to carry out the work at night, without conferring any right on the contractor to claim extra payment for night working. The decision of the Engineer in charge in this regard will be final and binding on the contractor.

12. Corrupt and Fraudulent practice.

- It is required that Bidders observe the highest standard of ethics during the procurement and execution of such contracts and not to indulge in any corrupt and fraudulent practice.
- "Corrupt Practice" means the offering, giving, receiving or soliciting of anything of value to influence the action of an official in the procurement process or in contract execution.
- "Fraudulent Practice" means a misrepresentation of facts in order to influence a procurement process or the execution of contract to the detriment of the Bank and includes collusive practice among Bidders (prior to or after bid submission) designed to establish bid prices at artificial non-competitive levels and to deprive the Bank of the benefits of free and open competition.
- The Bank reserves the right to reject a proposal for award if it determines that the Bidder recommended for award has engaged in corrupt or fraudulent practices in competing for the contract in question.
- The Bank reserves the right to declare a Bidder ineligible, either indefinitely or for a stated period of time, to be awarded a contract if at any time it becomes known that the firm has engaged in corrupt or fraudulent practices in competing for or in executing the contract.

13. Liquidated Damages:

Should the work not be completed to the satisfaction of the Site Engineer within the stipulated period due to Contractors default, the contractor shall be bound to pay to the Bank, a sum calculated as below by way of liquidated damages and not as penalty during which the work remains uncompleted or unfinished after the expiry of the completion date.

If the contractor fails to complete the work by the scheduled date of completion or within any sanctioned extended time, he will have to pay liquidated damages at rate of 0.5 % of the contract value for each week of delay subject to maximum of 10 % of the contract value.

14. Force Majeure:

- i. The Selected Bidder shall not be liable for forfeiture of its performance security, Liquidated damages or termination for default, if any to the extent that its delay in performance or other

failure to perform its obligations under the contract is the result of an event of Force Majeure.

- ii. For purposes of this Clause, "**Force Majeure**" means an event explicitly beyond the reasonable control of the Contractor and not involving the contractors fault or negligence and not foreseeable. Such events may be due to or as a result of or caused by act of God, wars, insurrections, riots, earth quake and fire, revolutions, civil commotion, floods, epidemics, quarantine restrictions, trade embargos, declared general strikes in relevant industries, satellite failure, act of Govt. of India, events not foreseeable but does not include any fault or negligence or carelessness on the part of the parties, resulting in such a situation. In the event of any such intervening Force Majeure, either party shall notify the other in writing of such circumstances or the cause thereof immediately within five calendar days.
- iii. Unless otherwise directed by the Bank in writing, the selected contractor shall continue to perform its obligations under the Contract as far as is reasonably practical, and shall seek all reasonable alternative means for performance not prevented by the Force Majeure event.
- iv. In such a case the time for performance shall be extended by a period(s) not less than duration of such delay. If the duration of delay continues beyond a period of three months, the Bank and the contractor shall hold consultations in an endeavor to find a solution to the problem.
- v. Notwithstanding above, the decision of the Bank shall be final and binding on the contractor regarding termination of contract or otherwise."

15. Available Bid Capacity/Financial Capability:

The bidder should possess the bidding capacity as calculated by the specified formula. The formula generally used is:

Available bid capacity = (A x M x N) - B, where

A = Maximum value of engineering (Civil/ Electrical/ Mechanical as relevant to work being procured) works executed in any one year during the last five years (updated at the current price level), taking into account the completed as well as works in progress.

M = Multiplier Factor (usually 1.5)

N = Number of years prescribed for completion of the work in question.

B = Value (updated at the current price level) of the existing commitments and ongoing works to be completed in the next 'N' years.

All costs and expenses incurred by interested bidders in any way associated with the development, preparation and submission of responses, including but not limited to the attendance at meetings, discussions etc. and providing any additional information required by the Bank, will be borne entirely and exclusively by the Bidder.

16. Electronic Reverse Auction.

The said work shall be put to electronic reverse auction before opening of the financial bids. Electronic Reverse Auction is a type of auction where the starting price, bid decrement, duration

of auction, maximum number of automatic extensions are announced before start of online reverse auction. The shortlisted bidders shall after the start of RA start bidding online in an iterative process wherein the lowest bidder at any given moment can be displaced by an even lower bid of a competing bidder, within the duration of the RA. If a new lower bid is received within last few minutes (say two minutes) of closing time, the closing time may get automatically extended by few minutes (at least five minutes) for others to respond. Maximum number of such extensions may be stipulated (at least five). The most favorable bid at the end of stipulated/extended time will be declared as successful. The Reverse Auction shall be scheduled for a fixed time period. Auctions may be arranged in any combination of time periods for e.g. (a) 1-1/2 hour viz. 1 hour with 6 extensions of 5 minutes each or (b) 1 hour viz. 1/2 hours with 6 extensions of 5 minutes each or (c) Unlimited extensions viz. 1/2 hour with unlimited extensions of 5 minutes each.

All the price bids (Indicative bids) submitted by the vendors shall be kept sealed to the event of e-reverse auction. At the end of reverse auction process the lowest Bidder (L1) will be selected on the basis of Total Price, including taxes.

In case the Prices arrived after Reverse Auction are more than the Indicative prices of any of the vendors, The Lowest Indicative prices of the vendor shall be considered and that vendor shall be declared the Lowest Bidder.

Bidding Example:

The final rates of the items shall be calculated in ratio of total amount quoted by the lowest bidder through reverse auction process and the amount quoted in indicative price bid, wherever specified in tender.

Example:

Indicative Price Bid submitted by vendor:

Item	Rate ®	Qty	Amount
A	100	2	200
B	200	3	600
C	300	4	1200
Total amount in Indicative price Bid			2000/-

The total amount mentioned in indicative price bid is Rs 2,000.00, but the final L-1 amount quoted by the vendor through E-reverse auction is Rs.1, 600.00, then the K factor for L-1 vendor will be calculated as under

Ratio K= (Total amount quoted by the lowest bidder through reverse auction process) / (The amount quoted in indicative price bid)

$K = 1600 / 2000 = 0.8$.

The item wise final price to be confirmed by the vendor shall be as under:

Item	Final Rate= $K \times R$	Qty	Amount
A	100×0.8	2	160
B	200×0.8	3	480
C	300×0.8	4	960
Total amount worked out after e- reverse auction			1600/-

17. After execution of the agreement with the successful bidder the relation of parties will be on principal to principal basis.

18. The Bidder shall not assign or outsource the works awarded by the Bank without the written consent of the Bank.

19. The successful bidder shall indemnify and keep J & K Bank, its Officers, Directors, employees indemnified in respect of any loss, damage or claim howsoever arising out of or related to breach

of contract, statutory duty or negligence by the firm or its staff, agents in relation to the performance or otherwise of the services to be provided under the contract.

20. Dispute resolution/arbitration: In the case of any dispute arising upon or in relation to or in connection with this agreement between parties, the disputes shall at the first instance be resolved through negotiations. If the dispute cannot be settled amicable within fourteen (14) days from the date on which either party has served written notice on the other of the dispute then any party can submit the dispute for arbitration under arbitration and conciliation Act, 1996. The sole Arbitrator shall be chosen by the bank.

The Place of Arbitrations shall be Jammu, India and the language of the arbitration proceedings and that of the documents and communication between the parties shall be English.

The Decision of the Arbitrator shall be final and binding upon the parties. The expenses of the arbitrator as determined by the arbitrator shall be borne equally.

The parties shall continue to be performing their respective obligation under this Agreement, despite the continuance of the arbitration proceedings, except for the disputed part under arbitration.

21. Each Bidder having responded to this NIT acknowledges to have read, understood and accepts the selection & evaluation process mentioned in this NIT documents. The bidder ceases to have any option to object against any of these processes at any stage subsequent to submission of its responses to this NIT.

22. All Notices or Communications under this software maintenance Agreement shall be first sent to E- mail to such e - mail addresses designated by each party, followed by registered post with acknowledged, where appropriate and required, to the address of each party first written above. A successful e mail delivery shall be treated as sufficient and complete delivery of the notice or communication. A notice by post will be sent by registered post acknowledge to the address set forth below, or such other address as it shall hereafter designate for this purpose:

In the case of a notice to the bank to:engineering.chq@jkbmail.com

In the case of a notice to contractor: email address registered with the bank.

Such notices shall be deemed to be received within four working days of the same being sent.

23. Bank reserves the right to select the next ranked bidder, if after selection the selected bidder withdraws his offer or bank detects wrong or misleading information in the proposal, In case the selected bidder withdraws his offer or if it is found that the information furnished by the bidder is wrong and misleading. Bank reserves right to take action as it deems fit, including forfeiture of EMD, claim for damages against the bidder.

24. Labour License:

All the Bidders must necessarily possess a valid Labour license (if applicable) obtained from concerned Govt. labour department. The said license is necessary for executing contract works under relevant provisions of different laws for the time being in force including but not limited to the Contract Labour (Regulation & Abolition) Act, 1970. It may be noted that no work order/Allotment shall be issued to the lowest bidders not submitting the relevant labour license.

25. Security Deposit:

No EMD is to be submitted with the tender documents. However, this being a limited tender among the already empanelled agencies, the agency quoting the lowest bid has to submit a security deposit of 2 % of the bid amount for a particular work. The security deposit shall be retained till the empanelment is valid or defect liability period of the particular work, whichever is later.

Pertinently, an agency getting multiple works through the tendering process shall have to deposit security deposit for every work, subject to a maximum aggregate ceiling kept by the Bank for a particular category an agency is empanelled in.

Example:

Consider an agency empanelled in “A” Category of Civil trade (1 crore to 2 crores).The agency has to submit an aggregate security deposit of Rs.3,00,000/- for the said category i.e. 2 % of the average limit of the category --- $2\% \text{ of } (1(\text{Lower limit of category})+2(\text{Upper limit of category}))/2 = 3.0 \text{ Lacs.}$

So the successful bidders will keep depositing 2 % of the bid value for each work till their aggregate security deposit with the bank reaches the limit of the category he/she is empanelled for.

(VI) SPECIAL CONDITIONS OF CONTRACT

1. If the Bank feels necessity of amending the specifications and or installing of any equipment / material which have not been quoted for by the contractor, the same shall have to be installed by the contractor which shall be paid as per actuals based on LMR and analyzed as per CPWD Schedule of Rates and analysis.
2. The commercial Bids of only those contractors / firms who qualify the prequalification laid by the Bank shall be considered.
3. The work shall be carried out strictly according to the terms & conditions, specification, design, drawing and plans. Where specifications do not cover any item, the specifications, terms and conditions of **UT** PWD / CPWD/ PDD in force shall be made applicable. All other terms and conditions not covered but in vogue in the CPWD shall hold good and form a part of the e-NIT.
4. No advance payment in the form of site mobilization advance, material advance etc. will be paid to Contractor. Running payments will be released after satisfactory completion of the portion of the works and measurement.
5. All other terms and conditions not covered but in vogue in the CPWD shall hold good and form a part of the e-NIT.
6. In the event of contract failure Bank reserves the right to terminate the contract after giving 20 days clear notice to the contractor and recover the amount of the loss caused by the damage, failure, default (including the consequently damage) as may be determined by The Assistant General Manager J&K Bank or his authorized representative.
7. The contractor shall provide company warranty cards of various items installed during the execution of works. Final bills shall be processed only after submission of the same.

(VII) ANNEXURES

- a) ANNEXURE A: SPECIFICATIONS AND BOQ FOR COMPOSITE WORKS.
- b) ANNEXURE B: LIST OF APPROVED MAKES.
- c) ANNEXURE C: STAGE PAYMENT SCHEDULE.
- d) ANNEXURE D: DRAWING
- e) ANNEXURE E: PRICE / COMMERCIAL BID FORMAT FOR COMPOSITE WORKS.

Annexure A

SPECIFICATIONS, BOQ FOR COMPOSITE WORKS

Abstract of Estimate for Development of new premises of Branch Panipat by of Composite works.			
Civil-Interior Works			
S No.	Particulars of Item	Unit	Quantity
1	Demolition of existing RCC Ducts, brick work, stair, partitions etc. and disposing the same outside the municipal limits of city.		
a	Existing Brick wall for opening to new premises	Cum	0.64
b	Removal of existing Cement Concrete in 1:3:6 mix or leaner mix	Cum	1
c	Removal of existing Cement Concrete in 1:4:8 mix or richer mix	Cum	1
d	Dismantling of existing tiles in flooring and walls and making good the surface for laying of new tiles including the cost of disposal outside the municipal limits of town. The job includes neatly cutting tiles with tile cutter and ensure that adjacent tiles are not damaged.	Sft	175
e	Dismantling of existing POP ceiling including its framework and disposal of all the removed material outside the municipal limits of town. Complete job as per the instruction of Engineer-in-Charge.	Sft	2165.3
2	Providing al layer POP over the floor in entire tile area to protect the surface from scratches and breakage. Complete job as per the instruction of Engineer-in-Charge.	Sft	2165.3
3	CEMENT CONCRETE: Providing and laying of cement concrete with crushed stone aggregates (quarry) 20mm nominal size including curing but excluding form work.		
a	1:4:8(1 cement : 4 coarse sand : 8 crushed stone aggregate 20 mm n/s)	Cum	1
b	1:3:6 (1 cement : 3 coarse sand : 6 crushed stone aggregate 20 mm n/s)	Cum	0.44
c	1:1.5:3 cement : 1.5 coarse sand : 3 crushed stone aggregate 20 mm n/s)	Cum	0.66
4	Providing & laying of Mulba including compacting the same, complete job.	Cum	0.82
5	STEEL WORK Reinforcement for RCC work including straightening, cutting, bending, placing in position and binding all complete with (Cold twisted bars). Make- TATA, SAIL, JINDAL or equivalent.	Kg	52.1
6	BRICK WORK: Brick work with common burnt clay machine moulded F.P.S. (non-modular) bricks of class designation 12.5 in exposed brick work in cement mortar 1:4 (1 cement (ACC) : 4 coarse sand, above plinth level up-to floor V level) including formwork, all complete.		
a)	4.5" Wall in 1:4 mix (1cement : 4 coarse sand)	Sqm	10
b)	9" Wall in 1:4 mix (1cement : 4 coarse sand)	Cum	7.48
7	PLASTER WORKS: Providing & doing 15mm thk plaster in 1:6 mix (1 cement : 6 coarse sand) including curing - all complete.	Sqm	70.63

8	VITRIFIED TILES: Providing and laying full body glazed polished vitrified tile free from all visible defects of size 600x600 (thickness to be specified by manufacturer) with water absorption less than 0.5% and conforming to ISO 13006:2018 of approved make Johnson and approved shade Johnson (S&P Beige) laid on 20mm thick cement mortar 1:4 (1 cement : 4 coarse sand) in all shapes & patterns and skirting (4" to be measured in SFT) with cement mortar or chemical -complete job. The job includes removal of old and damaged tiles and its disposal outside municipal limits. Complete job in all aspects.	Sft	350
9	VITRIFIED TILES: Providing and laying full body glazed polished vitrified tile free from all visible defects of size 1500 X 750 mm (thickness to be specified by manufacturer) with water absorption less than 0.5% and conforming to ISO 13006:2018 of approved make matching the existing shade of tiles to be laid with tile adhesive chemical or on 20mm thick cement mortar 1:4 (1 cement : 4 coarse sand) as per requirement in all shapes & patterns and skirting (4" to be measured in SFT) with cement mortar or chemical -complete job. The job includes removal of old damaged tile and its disposal outside municipal limits. Basic cost of tile is Rs 75 per Sft. Complete job in all aspects.	Sft	400
10	Providing and laying of already available vitrified tiles along with its grouting laid over with tile adhesive chemical or on 20mm thick cement mortar 1:4 (1 cement : 4 coarse sand) as per site requirement in all shapes & patterns in skirting (4" to be measured in SFT) with cement mortar or chemical -complete job. The job includes all cost of labour and material excluding the cost of Tiles. The job also includes removal of old and damaged tiles and its disposal outside municipal limits. Complete job in all aspects.	Sft	300
11	P/l of Ceramic Tiles free from all visible defects of size walls tiles of size as per item a & b of 1st quality confirming to IS: 13755, KAJARIA Somany, Nitco, Hindware, Johnson or eq or equivalent of approved shade laid over a 20mm thk bed of cement mortar 1:4 (1 Cement (ACC, Ambuja, ultratech or eq) :4 Corase sand) including pointing the joints with white cement and matching pigment etc, complete. Complete job in all aspects.		
a)	300X300 mm floor tiles.The tiles shall be approved by the bank before laying.	Sft	0
b)	300X450 mm wall tiles.The tiles shall be approved by the bank before laying.	Sft	0
12	P/l of chequerred tiles (vitrified exterior tiles) 300mm x 300mm size of first quality laid over a bed of 20mm thick cement mortar 1:4 including pointing the joints with white cement and matching pigment etc, complete for external areas in flooring & skirting. The tiles shall be approved by the bank before laying.	Sft	0
13	GRANITE WORKS: Providing and Laying of Granite 18mm thick over 20mm thick cement mortar 1:4 mix (1 cement :4 Coarse sand) and jointed with white cement slurry with pigment to match the shade with granite including the cost of Moulding-(Single moulding) of the Granite work including grinding and polishing on front nosing including all charges- complete job. Complete job including cost of all material & labour. The job includes removal of old and damaged granite and its disposal outside municipal limits.	Sft	286

14	WALL PUTTY Providing and applying wall putty to walls or ceiling, wherever required, using approved quality, following relevant specifications including all necessary surface preparation, making level pads, scaffolding, cleaning etc. complete at all levels and heights. The job also includes removal of old putty and its surface preparation for new coat of putty including disposal of removed putty.	Sft	6438.71
15	P/F of gyp board ceiling 12.5 mm thick over frame work with G.I suspended metal galvanised frame work and hangers of appropriate design with section to receive face @ 600 mm c/c with intermediate supports spaced at 1220mm max in ceiling . jointing/taping/compounding the gyp boards in a manner to give a seamless look- all complete	Sft	2113.11
16	LOW HEIGHT PARTITION P/F of low height Partition (4' Height Partition with 1'-6" Float Glass) having composite thickness of 111.5 mm consisting of aluminium frame (2.5" x 1.5")16 gauge Jindal or eq, double skin 12 mm thk plywood (Archid, Greenlam, Sonar, Century or eq) finished with 1 mm thick laminate of approved shade with its frame work fixed to floor/walls at a spacing of 600mm c/c both ways by 6mm dia nuts, bolts, studs- complete job.(including any sort of cutting in the partition for installing electric switches, board, making of grooves for fitting of glass making good the item, all complete, including labour & materials). The top of the partition is to be finished with 1st quality Teak Wood 25mm thk & melamine polished of approved shade. All complete as per the instruction of Engineer-in-charge (Prior approval from concerned engineer must be sought for equivalent make).	Sft	100
17	Gyp Finish- P/f of Partition (Partially Solid,Patially Glazed) having composite thickness of 111.5 mm consisting of frame and double skin 12mm thk plywood (Century (Sainik), Greenply (Ecotec), Archidply, Sonar or eq) and also double skin 12.5mm thk gypsum board (Gyproc, USG Boral or eq), including P/f of frame work made of aluminium sections of 2.5" x 1.5" fixed to floor/ ceiling at a spacing of 600mm c/c by 6 mm dia nuts and bolts and studs at both ends - complete job including jointing / taping the gyp in a manner to give a seamless & edgeless look- all complete including making 10mm thick visible grooves for skirting as per approved drawings. This includes making space for fixing of glass in the partition if required and (including any sort of cutting in the partition for installing electric switches, board) (Glass shall be deducted from partition & shall be paid separately).	Sft	329.54
18	P/F of Beeding (3.5 inches wide) on the joints of gyp and glass in partitions made out of 4mm thk recon veneer duly polished in melamine of approved color - complete job including cost of materials and labour.	Rft	0
19	P/F of float glass in doors, windows, partitions, counter seperations. Complete job including cost of labour and material.		
a)	12mm Float Glass	Sft	139.75
b)	8mm Float Glass	Sft	20
c)	5mm Float Glass	Sft	20
18	Making and doing itching, moulding etc. of different profiles		
a)	Pencil Moulding	Rft	20
b)	Grinding	Rft	201

c)	Bewelling	Rft	33
20	P/F of Toughened glass in glazed partitions including grooving of the surfaces for fitting of the glass - complete job including cost of labour and materials		
a)	12mm thick Glass	Sft	331
21	P/F of <u>toughened glass for doors</u> including making of holes etc. for different types of patch fittings - complete job including cost of labour and materials but excluding cost of patch fittings.12 mm thick	Sft	84
22	Providing and fixing of Floor Spring Ozone 8400/Ozone 8400(S) with spindle, cover plate, top and bottom patches, pivot and lock, SS Handle -- complete set.	Set	4.00
23	P/F of different hardware items of approved brand and specifications:		
a	SS Connectors	No.	20
b	SS L Patch fitting (Big)	No.	5
c	SS L Patch fitting (Small)	No.	5
24	Applying two or more coats of plastic emulsion of approved brand (Asian paints, Nerolac, Dulux, Berger or eq) to give an even shade and color after thoroughly brushing the surface, clean of all grease and dirt, loose pieces of seals including preparing the surface with sand paper smooth (complete job including cost of materials, scaffolding and labour) (Painting to be done with the help of rollers on walls and ceiling)	Sqm	598.39
25	Painting two or more coats of synthetic enamel over wood/steel and wood/steel based surfaces of approved brand (Asian paints, Nerolac, Dulux, Berger or eq) and shade including cleaning the surface from all dirt, dust and foreign matter knotting and sandpapering (Complete job including cost of materials, scaffolding and labour).	Sqm	95.96
26	Applying two or more coats of exterior weather proof paint of approved shade and make (Asian paints, Nerolac, Dulux, Berger or eq) over wall surfaces, including cleaning the surface of all dirt, dust and foreign matter and sand papering including cost of all labour, scaffolding and material. (Painting to be done with the help of brushes on walls and ceiling)	Sqm	23.23
27	Sanitary items-Providing & Fixing sanitary items including excavation (if required) and after installing covering it with 1:3:6 concrete and making the things good complete job		
a	CP Angle valve (Basic series, Jaquar, Hindware, Cera or eq)	No.	1
b	C P Gratting	No.	1
c	Urinal Small (Cera) white	No.	1
d	PVC Waste Pipe	No.	1
e	CP waste Coupling	No.	2
28	P/f of Aluminium Composite Panels (ACP) of ALSTONE, EUROBOND or eq. in wall cladding, ceiling and over frame of Aluminium offset with necessary screws and dash fasteners (4 mm thick with 0.25mm skin thickness), complete job.	Sft	450

29	P/F of various Aluminium sections in & under ACP on walls, ceiling and frame of doors with necessary screws & dash fasteners but excluding cost of ACP:		
a	2.5" x 1.5" (16 Guage)(Jindal or Eq)	Rft	198
b	1" x 1.5" (16 Guage)(Jindal or Eq)	Rft	240
30	P/F of 6 mm thick ply at the back side of ATM partition wall including synthetic enamel paint of approved shade/Brand complete.	Sft	48
31	Applying Silicon adhesive Band (999) Glue in ACP joints & gap filler.	Rft	124
32	Structural steel work in built up sections, trusses and framed work, including cutting, hoisting, fixing in position and applying a priming coat of approved steel primer all complete.(Welded upto height of 12 feet)	Kg	230.02
B	Providing and fixing stainless steel (Grade 304) railing made of Hollow tubes channels, plates etc. including welding ,grinding, buffing, polishing and making curvature (wherever required) and fitting the same with necessary stainless steel nuts and bolts complete ,including fixing the railing with necessary accessories and stainless steel dash fasteners, stainless steel bolts etc. of required size, on the top of the floor or the side of waist slab with suitable arrangement as per approval of Engineer-in-charge, (for payment purpose only weight of stainless steel members shall be considered excluding fixing accessories such as nuts, bolts, fasteners etc.)	KG	30

Furniture works

33	P/F of front desk/ running counters of "face to face Type" of approved design and specifications made out of 18mm thk plywood (Greenlam, Archid, Century or eq) with 35mm thk post formed top of width 2'-3". All exterior surfaces are to be finished in 1mm thk laminate and interior sides of table are to be finished in 0.8mm laminate and keyboard tray of 1'10" x 1'4" made out of 18mm plywood duly finished in 1mm laminate of matching shade on all sides. The partition between two successive counters has to be 3" thick and size 2' x 3' made out of frame work of Aluminium section (16 guage) of 2" x 1.5" and double skin 12mm plywood finished in 1mm thick laminate on all sides. The partition is to provide with a groove on top for fixing of 12mm thick float glass for a height of 2'-0" from the table top. The partition are to be provided at every 4' length c/c. The front desk is to be provided with a fixed pedestal which will include a single line drawer of size 0'-5" X 1'-4" X 1'9", bottom storage of size 2' X 1'-4" X 1'9" finished with 1 mm laminate on outer face and 0.8mm laminate on inner surfaces. Rates are inclusive of hardware, channels, locks, handle etc. of make hettich, godrej, haffelle or eq. but excluding the cost of glass which shall be paid separately. Complete job as per instructions of Engineer-In-Charge and drawings. Complete job including cost of labour and material and cutting charges for fixing of float glass in counter partition.(Prior approval from concerned Engineer must be sought for equivalent make).	Rft	26
----	--	-----	----

34	<p>P/F of cash tellers table in cash cabins made out of 18mm thk Plywood with 35mm thk postformed top of width 2'6". All exterior surfaces are to be finished in 1mm thk laminate and interior sides of table are to be finished in 0.8mm laminate and keyboard tray of 1'10" x 1'4" made out of 18mm plywood (Greenlam, Archid, Century, or eq) duly finished in 1mm laminate of existing matching shade on all sides. The partition between two successive counters has to be 3" thick and size 2' x 3' (in addition to the platform height) made out of frame work of aluminium section (16 guage) of 2" x 1.5" and double skin 12mm plywood finished in 1mm thick laminate on all sides. The partition is to be provided with a groove on top for fixing of 12mm thick float glass for a height of 3'-0" from the table top'. The partition are to be provided at every 4' length c/c or as per site requirement. The cash teller table is to be provided with a fixed pedestal which will include a single line drawer of size 5" X 1' 4" X 1'9", bottom storage of size 2' X 1'4" X 1'9" finished in 1 mm laminate on outer face and 0.8mm laminate on inner surface. Rates are inclusive of hardware, channels, locks, handle etc. of make hettich, haffelle or eq but excluding the cost of glass which will be paid seperately. Complete job as per instructions of Engineer-In-Charge and drawings. Complete job including cost of labour and marterial and cutting charges for fixing of float glass in counter partition.(Prior approval from concerned engineer must be sought for equivalent make).</p>	Rft	5
35	<p>M/S a Unit Head Table of desired dimensions, made out of 18mm plywood (Greenlam, Archid, Century or eq) with 3" thk top and side panels finished in 1 mm laminate of matching shade . The internal side of table are to be finished in 0.8mm thick laminate of approved shade. The cost shall include the cost of pedestal unit fixed to the table top and sides of desired dimentions, outer framework for side panels made out of 18mm plywood (Green Ecotec, Century, sainik , Archid silvi or sonear ply or eq) and bottom of the drawer made out of 12 mm thick ply of approved brand and specification and all exterior faces to be finished in 1mm thick laminate including all hardwares like channel, lock, handle etc The storage unit shall include the following a) Single line drawer of size 1'4"x5" x 1'9" b) Bottom storage of size 2' x 1'4"x1'9" all complete as per the instructions of Engineer-In-Charge & as per approved drawings.(Prior approval from concerned engineer must be sought for equivalent make).</p>	Sft	31
36	<p>M/S a " May I Help You" table of desired dimensions made out of 18mm Plywood (Century or eq) with 35mm thick Post Formed top, side panels finished in 1mm laminate of approved shade. The desk is also to be provided with a space for keyboard. The internal sides of the desk are to be finished in 1mm thk laminate of approved shade. the table is also to be provide with 35mm thk post formed ledge on top resting on a 2'4" wide front panel apron finished in american walnut laminate including all hardwares like channel, lock, handle etc. The storage unit shall include the following a) Single line drawer of size 1'4"x5" x 1'9" b) Bottom storage of size 2' x 1'4"x1'9" all complete as per the instructions of Engineer-In-Charge & as per approved drawings.(Prior approval from concerned engineer must be sought for equivalent make).</p>	Rft	5

37	M/S a "Side Credenza" of desired dimensions made out of 18mm plywood (Greenlam, Archid, Century or eq) with top finished in 1mm thk laminate, with a single line drawer finished internally in 0.8mm thk laminate and front finished in 1mm thk laminate with necessary hardware attachments. The internal sides of the table are finished in 0.8mm thk laminate of approved shade & make. The side credenza includes a) Single Line Drawer b) Bottom Storage unit of desired size (Cost to include all necessary hardware like modular hinges, SS Handles (4"), Dead locks, etc)- All complete as per the instructions of Engineer-In-Charge & as per approved drawings. (Face Area Measurement) (Prior approval from concerned engineer must be sought for equivalent make).	Sft	17.5
38	P/F of Partition for cash cabin having composite thickness of 88.5 mm consisting of frame and double skin 12 mm thick plywood (Greenlam, Archid, Century or eq) and also double skin 1mm thk Laminate of approved shade, including P/F of frame work made of aluminium sections 2.5"x1.5" gauze 16 fixed to floor/ walls at a spacing of 600mm c/c by 6 mm dia nuts and bolts and studs at both ends - complete job , as per approved drawings & instructions of Engineer-In-Charge. (Prior approval from concerned engineer must be sought for equivalent make).		
a	Both side Laminate partition (frame + both side ply 12mm + both side 1mm Laminate).	Sft	36.59
b	Single side Laminate partition (frame + single side ply 12 mm + single side 1mm laminate).	Sft	80
39	MDF Jaali		
a	Providing & fixing of lattice work in partition as per the approved design made out of MDF Jaali 12 mms thick (polished to match the shade of furniture or as required) to be fixed in the grooves in the cash cabin partitions or any other location as specified. Complete job including cost of material, labour etc. (Prior approval from concerned engineer must be sought for equivalent make).	Sft	12
b	Providing & fixing of lattice work in partition as per the approved design made out of MDF Jaali 6 mms thick with mica of approved shade as per Engineer at back of MDF Jaali to be fixed in the grooves in the cash cabin partitions/front desks/in charges table or any other location as specified. Complete job including cost of material, labour etc.	Sft	47.58
40	P/F of storage racks of approved design and specifications made out of 18mm plywood(Greenlam, Archid, Century or eq) for stationary room, without shutters, back made out of 6mm thk plywood with 16" x 16" spacing and depth of 16". All outer edges are to be covered with 18 mm wide wooden Beeding (Plain) and all internal and external surfaces are to be painted in synthetic enamel of approved color & as per approved drawings & instructions of Engineer-In-Charge. - Complete job including cost of materials and labour (Face area measurement).(Prior approval from concerned engineer must be sought for equivalent make).	Sft	0

41	P/F of storage almirah of approved design made out of 18mm Plywood (Greenlam, Archid, Century or eq) including shutters of width 1' finished in 1mm laminate. The depth of the almirah is to be 16". All outer sides are to be finished in 1 mm laminates (approved make and shade) & internal surfaces to be finished in 0.8 mm laminate of approved make & shade - including cost of all materials and labour, complete in all respect as per the instructions of Engineer-in-charge & as per approved drawings. The almirah shall include one horizontal shelf .(Cost to include all necessary hardware accessories like modular hinges, SS Handles (4"),dead locks, etc) (Face area measurement)(Prior approval from concerned engineer must be sought for equivalent make).	Sft	150
42	Sofa with Arm		
a	Providing/fixing of Sofa with arm as per layout plan or as per direction of Engineer in Charge- sofa with arms on inner solid Frame structure and legs made of Deodar wood. All the exposed wood surfaces (legs/sides etc.) are to be polished(melamine). The seat cushions on seat & back is to be made of 34 Density foam 4" thick of approved make on 18/12 mms thick ply wood (Greenlam, Archid, Century or eq) with extra supports of plywood as per requirements with polyester polyfill outer to keep the upholstery wrinkle free and soft of Approved make & shade , complete job including cost of all material like wood framework, foam, polyfill fabric over cushion, back, arms and back, labour charges etc as approved by Engineer in Charge(Prior approval from concerned engineer must be sought for equivalent make).	Seats	6
43	P/F of sattles made out of 18mm thk plywood (Century, Greenlam, archid or eq.) with back rest with 100mm thk latex rubber pincare sheeting lined on both sides 12 mm medium density polyfoam mounted with handloom fabric -- complete job (Prior approval from concerned engineer must be sought for equivalent make).	Rft	12
44	P/f of 2'6"x1'6" writing ledge attached to wall with 6 number of drop box made out of 18mm of plywood (Greenlam, Archid, Century or eq) to be finished with 1mm laminate of approved shade to be fabricated as per design, approved drawing and engineer incharge including labour and material. The writing ledge is to be supported with suitable supports. (Prior approval from concerned engineer must be sought for equivalent make).	No.	1
45	Providing and fixing of flush door shutters, core of block board, single leaf, 35mm thk solid door finished in 1mm thk laminate (Century, Greenlam, archid or eq. Mica - shade 21127) on all sides and edges - complete job. Including cost of MS Hinges (4")-3 no.(Prior approval from concerned engineer must be sought for equivalent make).	Sft	87.50
46	P/f of door frame made out of 18mm/12 plywood (Greenlam, Archid, Century, Kitply or eq) fixed in grooves finished in 1mm laminates of approved make & shade, & as per approved drawings, complete in all respects as per the instructions of Engineer-In-Charge.(Prior approval from concerned engineer must be sought for equivalent make).	Sft	65.25
47	P/F of CPU Stands made up of 18mm ply (Greenlam, Archid, Century or eq) painted all over in synthetic enamel paint of approved brand and shade (size 18" x9" x 4").Complete job including cost of labour and material. (Prior approval from concerned engineer must be sought for equivalent make).	No.	10

48	P/F of Footrests made of 18mm thk ply (Greenlam, Archid, Century or eq) with slanted top(front height 4" and back height 2.5") painted all over in synthetic enamel paint of approved brand and shade (size 12" x16"). -Complete job including cost of labour and material.(Prior approval from concerned engineer must be sought for equivalent make).	No.	10
49	Providing Cut holes in tables and glass top and Fixing of PVC/SS Wire managers.Complete job including cost of labour and material.	No.	10
50	Removal of old wood partition from wall and disposal of the same outside municipal limits or stacking of the usable material at site.	Sft	100
51	P/F of different hardware items of approved brand and specifications:		
a)	Arl SS 200mm (Godrej or eq)	No.	4
b)	Handle 6" SS Finish(Godrej or eq)	No.	8
c)	Cylindrical Lock	No.	1
d)	Dead Lock Godrej	No.	1
e)	Tower bolt SS 8"	No.	8
f)	Tower bolt SS 4"	No.	1
g)	Door Stopper	No.	4
h)	Door Closer (Hyper, Godrej or eq)	No.	4
52	Rate for Lighting point in 2x1.5 sqmm PVC insulated FR multistrand flexible cu wire and earthing with 1x1.5 sqmm wire through 25 mm dia 2mm thick PVC conduit.The job shall include the cost of wires, switches,face plate, jn boxes Boxes etc . The contractor shall made good the losses if any.		
	a) Primary point	No	30.00
	b) loop point from existing primary point	No	25.00
53	Rate for Fan point in 2x1.5 sqmm PVC insulated FR multistrand flexible cu wire and earthing with 1x1.5 sqmm wire through 25 mm dia 2mm thick PVC conduit.The job shall include the cost of wires, 6A switch, 6A socket,face plate, jn boxes, without MS Boxes etc .The contractor shall made good the losses if any.	No	2.00
54	Rate for Fan point in 2x1.5 sqmm PVC insulated FR multistrand flexible cu wire and earthing with 1x1.5 sqmm wire through 25 mm dia 2mm thick PVC conduit.The job shall include the cost of wires, 6A switch, 6A socket,face plate, jn boxes, with MS Boxes etc .The contractor shall made good the losses if any.	No	15.00

55	Rate for Heating point in 2x2.5 sqmm PVC insulated FR multistrand flexible cu wire and earthing with 1x2.5 sqmm wire through 25 mm dia 2mm thick PVC conduit.The job shall include providing of 1 No 16 A socket, 1 No 16 A switch Face Plate.jn boxes etc .The contractor shall made good the losses if any. as per details below :-		
	a) Heating point with less than 11 mtr distance from DB	No	1.00
	b) Loop from existing Heating point point	No	1.00
	c) Heating point with more than 11 mtr distance from DB (<20 mtr)	No	1.00
	d) Heating point with more than 20 mtr distance from DB	No	1.00
56	Rate for A/C point in 2x4.0 sqmm PVC insulated FR multistrand flexible cu wire and earthing with 1x4.0 sqmm wire through 25 mm dia 2mm thick PVC conduit.The job shall include providing of 1 No 20A SPN Industrial socket with box .etc.The contractor shall made good the losses if any. (as per details below :-		
	a) A/C point with less than 11 mtr distance from DB	No	2.00
	b) A/C point with more than 11 mtr distance from DB	No	3.00
	c) A/C point with more than 20 mtr distance from DB	No	2.00
57	Rate for 6 A UPS / RP Point wiring in 2x2.5 sq. mm PVC Insulated flexible FR multistrand cu. Wire and earthing the third pin with 1x2.5 sqmm wire through PVC conduit 25 mm dia 2mm thick.The job shall include providing of 6/16 A sockets, 6/16 A switches, Face Plate.jn boxes etc .The contractor shall make good the losses if any as per details below :-		
	a) 1 No 6A Socket & 1 No. 6A switch from UPS/RP DB	No	3.00
	b) Loop point of 1 No 6A Socket & 1 No. 6A switch from existing point	No	3.00
	c) 1 No. 6A socket, 1 No 16A Socket & 1 No. 16A switch from UPS/RP DB	No	1.00
	d) Loop of 1 No. 6A socket, 1 No 16A Socket & 1 No. 16A switch from existing point	No	1.00
	e) 2 No. 6A socket, & 1 No. 16A switch from UPS/RP DB	No	7.00
	f) Loop of 2 No. 6A socket, & 1 No. 16A switch from existing point	No	7.00
	g) 3 No. 6A socket & 1 No. 16A switch from UPS/RP DB	No	3.00
	h) Loop of 3 No. 6A socket & 1 No. 16A switch from existing point	No	2.00
	i) 4 No. 6A socket from UPS/RP DB	No	2.00
	j) Loop 4 No. 6A socket from existing point	No	2.00
58	Supply & fixing of UPS Input Output point consisting of 2 No.16A Sockets on 6 module metal flush box with PVC plate & 2 No. blankers etc. The scope shall also include chiseling work and to make good the losses if any.	No	2.00
59	Providing & fixing of PVC insulated FR multistrand copper wire		
	a) 1.5 sq mm	Mtr	250.00
	b) 2.5 sq mm	Mtr	300.00
	c) 4.0 sq mm	Mtr	100.00
	d) 6.0 sq mm	Mtr	100.00

	e) 10.0 sq mm	Mtr	100.00
60	Providing and fixing of 3.5 Core x 50 sq. mm. armored Aluminum Cable 1100 V grade as required. The scope includes laying the cable by clamping in the wall, laying in the soil etc. as required and cable end terminations with suitable size lugs and glands	Mtr	40.00
61	Supply, Laying & fixing of Cat 6 Data Cable in existing PVC conduit including termination charges	Mtr	640.00
62	Supply, laying & fixing of PVC insulated 0.4 sqmm 2 pair Telephone copper wire in existing PVC Conduit	Mtr	360.00
63	Supply & Laying of medium-Grade PVC Conduit of 25 mm dia & 2 mm thickness	Mtr	250.00
64	Supplying, installation, testing and laying of 8 SWG bare Copper wire for Earthing	Mtr	20.00
65	Providing, fixing, installation, commissioning & testing of 1' x 1' 24 Watt recess Square LED lighting fixtures (commercial/professional grade having die cast Aluminium body with total lumen output of 1920 or more)	No	28.00
66	Providing, fixing, installation, commissioning & testing of 15 Watt LED Recess Round lighting fixtures (commercial/professional grade having die cast Aluminium body with total lumen output of 1200 or more)	No	20.00
67	Providing, fixing, installation, commissioning & testing of 4 feet Batten 18W or above (commercial/professional grade having extruded polycarbonate housing with total lumen output of 1800 or more)	No	4.00
68	Providing, fixing, installation, commissioning & testing of 2 feet LED Batten 10W or above (commercial/professional grade having extruded polycarbonate housing with total lumen output of 1000 or more)	No	2.00
69	Supply, installation, commissioning & testing of 400 mm wall fan	No	10.00
70	Supply, installation, commissioning & testing of 300 mm Cabin fan	No	1.00
71	Supply, installation, commissioning & testing of 150 mm Exhaust fan	No	3.00
72	Supply, installation, commissioning & testing of 300 mm heavy duty Exhaust fan	No	1.00
73	Supply, installation, commissioning & testing of RJ-45 Krone networking data Jack including face plate with 1 No. RJ 45 jack including 1/2 module plate	No	20.00
74	Supply, installation, commissioning & testing of RJ-11 Telephone jacks including face plate with 1 No. Rj11 jack including 1 module plates	No	12.00
75	Supply, installation, testing and commissioning of following items for Rack		
	a) Supply, installation, testing and commissioning of fully loaded 12 U Networking Rack. Fully loaded includes axial exhaust fans, Hardware packet, cable Manager, 5 No. 6A Sockets, 1U cantilever Shelf tray etc.	No	1.00

	b) Supply, installation, testing and commissioning of Fully Loaded 24 port Patch Panel	No	1.00
	c) Supply & fixing of Patch Cords		
	i) 1 Meters	No	30.00
	ii) 2 Meters	No	2.00
76	Supply, installation, testing and commissioning of 4 way double Door (TPN) (8+12module) Distribution Board	No	2.00
77	Supply, installation, testing and commissioning of 6 way double Door (TPN) (8+18module) Distribution Board	No	1.00
78	Supply, installation, testing and commissioning of 12 way double Door (SPN) Distribution Board	No	1.00
	Supply & fixing of MCCB/ MCB as per detail:-		
	a) MCCB TPN 100A 10KA	No	1.00
	b) MCCB TP 100A 10KA	No	1.00
	c) MCB FP 40A/ 63A, 10KA C curve	No	2.00
	d) MCB FP 6A/ 32A, 10KA C curve	No	4.00
	e) MCB DP 40 - 63A, 10KA C curve	No	2.00
	f) MCB DP 6 - 32A, 10KA C curve	No	13.00
	g) MCB SP 6 - 32A, 10KA C curve	No	42.00
80	Rate for fabrication, supply, installation, testing and commissioning of compact cubical indoor type dust proof sheet steel powder coated LT switchgear panel suitable for 440 V, 3 phase 4 wire, 50 Hz power distribution system complete with cable inter connections, Al Bus Bar (TPN) & other accessories (per cuft). The panel shall be Indoor type, free standing, floor/ wall mounting, sheet metal clad, cubicle, dead front, dust and vermin proof type compartmentalized design fabricated out of powder coated 16 SWG sheet steel (shade grey), complete with Electrolytic high conductivity Aluminum TPN of appropriate rating insulated with heat shrinkable PVC sleeves, separate earth bus bar to be provided through out the length of the panel. Adequate size cable alley, painting, earthing, numbering, danger plate etc as required.		
	3'x3'x1'	cuft	9.00
81	Providing & fixing of 100A FP Changeover	No	1.00
82	Supply & fixing of Voltmeter/Ammeter in panel 3 phase digital type	No	1.00
83	Supply & fixing of Indicator in panel	No	3.00
	Supply & fixing of thimbles		
84	a) Cu/Aluminum thimbles (2.5/4/6/10sqmm)	No	150.00
	b) 50 sqmm Aluminum thimbles	No	8.00
85	Supply & fixing of 3 pin 6A top	No	4.00
86	Supply & fixing of 3 pin 16A top	No	2.00
87	Supply & fixing of ferule	No	200.00

88	Supply & fixing of FP 63A Connector	No	2.00
89	Supply & fixing of Ceiling rose with pvc block	No	4.00
90	Supplying, installation, testing and commissioning of Hooter point in 2 x 1.5 sqmm PVC insulated FR multistrant copper wire through PVC conduit of 25 mm dia and 2 mm thickness. The job includes complete job i.e. cost of wires, conduit, 6A switch, face plate, junction box, Hooter etc.	No	1.00
91	Supply, installation, testing and commissioning of 4 zone intrusion panel including 12 V battery capable of providing backup of 24 hrs. with key operations, LED indicators, capable to connect with high voltage siren & in built digital communicator for i) CMS connectivity through LAN & Telephone ii) Micro controller based inbuilt speech auto dialer	No	1.00
92	Supply, installation, testing and commissioning of Hand operated Panic switch for security alarm system	No	6.00
93	Supply, installation, testing and commissioning of Magnetic contacts (heavy duty metal contacts) for security alarm system	No	2.00
94	Supply, installation, testing and commissioning of PIR motion sensor for security alarm system	No	2.00
95	Supply, installation, testing and commissioning of Beacon lights for security alarm system	No	2.00
96	Supply, installation, testing and commissioning of Hooter for security alarm system	No	2.00
97	SITC of Earthing station as called for in 2m x 50mm GI Pipe with Copper Electrode of 2100mmx25mmx6mm with requisite Back fill compound (2 bags of 15kg/ 30kg (1 bag)) acting as moisture booster ground enhancement material placed all around the electrode in a bore of minimum diameter of 5 inch to make a safe maintenance free chemical earthing. The whole assembly should be covered by a Cast Iron main hole cover fitted in concrete mixture of 4:1.around 6" perimeter and 6" depth. The copper electrode should be provided with Nut and bolt of Brass with Copper thimble of appropriate size.	No	3.00
98	Supply, installation, testing and commissioning of smoke detectors	No	17.00
99	Supply, installation, testing and commissioning of heat detectors	No	1.00
100	Supply, installation, testing and commissioning of main control panel with battery back up of 16 hrs. with 2No. 12V battery (2 Zone)	No	1.00
101	Supply, installation, testing and commissioning of strobes/Horns	No	2.00
102	Supply, installation, testing & commissioning of manual call Point	No	2.00
103	Providing and fixing of Response Indicator	No	3.00

ANNEXURE B
LIST OF APPROVED MAKES

LIST OF MAKES OF DIFFERENT MATERIALS REQUIRED FOR DEVELOPMENT OF BUSINESS UNITS		
S. No.	Description	Approved Brands to be used
INTERIOR AND FURNITURE		
ITEMS		
1	Plywood	Greenply (Ecotec), Century (Sainik), Archidply, Sonear or eq
2	Veneers	Reconstituted Veneer 4mm thick basic cost Rs 1500 per sheet of size 8'-0" x 4'-0" of Greenply (Ecotec), Century (Sainik), Archidply, Sonear or eq
3	Laminates	Merino, Greenlam, Century, Archid or eq
4	Gypsum Board	Lafarge, Saint Gobain (Gyproc).
5	Cement	Khyber, Ambuja Cements, Ultratech, ACC or eq
6	Vitrified Tiles (Full Premium Quality)	Kajaria, Nitco, RAK, Jhonson, Hindware or eq
7	Ceramic Tiles	Nitco, Kajaria, Somany, RAK or eq
8	Wall Putty	Birla, JK or eq
9	Plastic Emulsion	Asian paints, Nerolac, Dulux, Berger or eq
10	Synthetic enamel	Asian paints, Nerolac, Dulux, Berger or eq
11	Cement primer	Asian paints, Nerolac, Dulux, Berger or eq
12	Wood primer	Asian paints, Nerolac, Dulux, Berger or eq
13	Patch Fittings	Ozone (8400), Dorma (BTS 65), Enox or eq (double cylinder)
14	Dead Locks Hardware	/ Godrej, Hettich, Ozone, Link or eq
15	G.I Pipes	B - Class; Prakash Surya, Jindal, Tata or eq
16	PVC Pipes	B- Type; Finolex, Astral, Prince, Supreme or eq
17	CPVC Pipes	Finolex, Astral, Price or Eq.
18	CI Pipe	Jindal, Finolex or Eq.
19	FLOAT GLASS/Toughened Glass	Asahi, Saint Gobain, Gold Plus or eq
20	Pump	Crompton Greeves, Kirloskar or Eq
21	Hot Water Geyser	Venus, Crompton, Havells, Bajaj, Racold, Jaquar, Morphy Richards or eq

22	Sanitary Items	Basic series, Jaquar, Hindware, Cera, Parryware or eq
23	SS Railing	Grade 202 for interior works
24	Roller Blinds	Vista, MAC or eq
25	Aluminum Sections	Jindal or Eq
26	Aluminum Composite panels	ALSTONE, EUROBOND or eq

Annexure C

STAGE/RUNNING PAYMENT SCHEDULE

ANNEXURE- D----- SCHEDULE FOR STAGE/RUNNING PAYMENTS			
		Items to be completed	% age of estimated cost to be released
1.	Civil/Interior Items		
	Stage 1st	Basic civil Works	Up to 40 %
		Grinding and Polishing of Floor	
		Melamine polish	
		Painting	Up to 60 % (Less payment already done)
	Stage 2nd	Steel work	
		Plumbing work	
	Stage 3rd (Final Bill)	Complete	As per the actual billed amount
2.	Electrical Items		
	Stage 1st	Laying of conduits and wires in the floor for data cables and UPS along with its switch series	Up to 50 %
		Laying and fixing of conduits and wires for lighting points, wall fan points, exhaust fan points and heating points	
		SITC of lighting fixtures in the ceiling and distribution boards in the walls	
	Stage 2nd	Installation of switch series for lighting, heating, UPS, Data, Telephone.	Up to 75 % (Less payments already Done)
		Installation of MCBs in the DBs	
		Installation of wall fans	
	Stage 3rd (Final Bill)	Complete in all respects (Besides 1 and 2, Installation of panels, patch panels, rack, service cables etc.)	As per the actual billed amount
3	HVAC Works	Running bills to be submitted on detailed measurements	As per the actual billed amount

ANNEXURE D

DRAWING

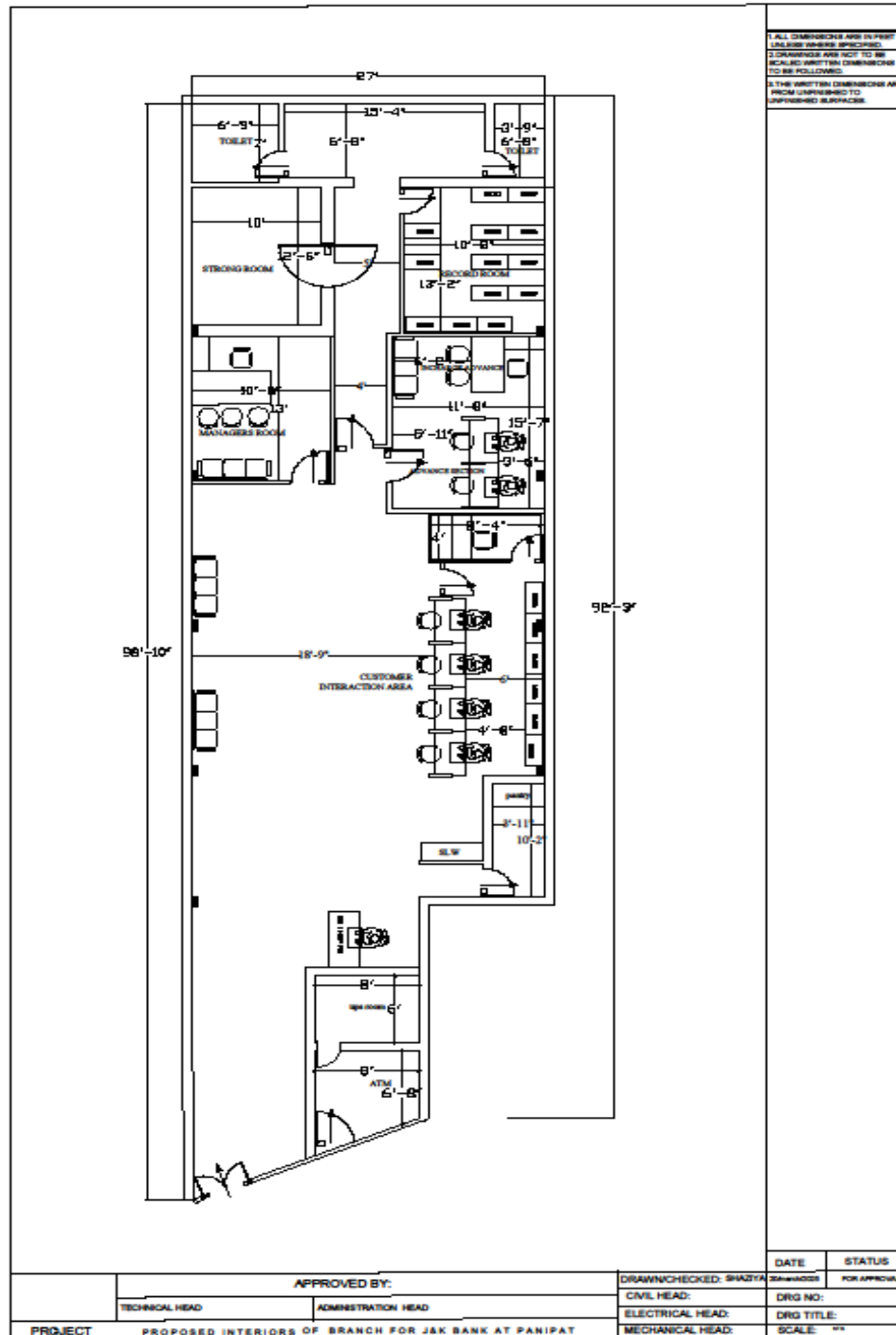

Layout of Bran

ANNEXURE E

COMMERCIAL /PRICE BID FORMAT

S No.	Particulars of Item	Unit	Quantity	Rate	Amount
1	Demolition of existing RCC Ducts, brick work, stair, partitions etc. and disposing the same outside the municipal limits of city.				
a	Existing Brick wall	Cum	0.64		
b	Removal of existing Cement Concrete in 1:3:6 mix or leaner mix	Cum	1		
c	Removal of existing Cement Concrete in 1:4:8 mix or richer mix	Cum	1		
d	Dismantling of existing tiles in flooring and walls and making good the surface for laying of new tiles including disposal.	Sft	175		
e	Dismantling of existing POP ceiling including its framework and disposal of all the removed material outside the municipal limits of town.	Sft	2165.3		
2	Providing al layer POP over the floor in entire tile area to protect the surface from scratches and breakage.	Sft	2165.3		
3	CEMENT CONCRETE: Providing and laying of cement concrete with crushed stone aggregates (quarry) 20mm nominal size including curing but excluding form work.				
a	1:4:8(1 cement : 4 coarse sand : 8 crushed stone aggregate 20 mm n/s)	Cum	0.44		
b	1:3:6 (1 cement : 3 coarse sand : 6 crushed stone aggregate 20 mm n/s)	Cum	0.66		
c	1:1.5:3 cement : 1.5 coarse sand : 3 crushed stone aggregate 20 mm n/s)	Cum	0.82		
4	Providing & laying of Mulba including compacting the same, complete job.	Cum	1		
5	STEEL WORK for reinforcement	Kg	52.1		
6	BRICK WORK				
a)	4.5" Wall in 1:4 mix (1cement : 4 coarse sand)	Sqm	10		
b)	9" Wall in 1:4 mix (1cement : 4 coarse sand)	Cum	7.48		
7	PLASTER WORKS: Providing & doing 15mm thk plaster in 1:6 mix (1 cement : 6 coarse sand) including curing - all complete.	Sqm	70.63		
8	VITRIFIED TILES: Providing and laying full body glazed polished vitrified tile free from all visible defects of size 600x600mm	Sft	350		
9	VITRIFIED TILES: Providing and laying full body glazed polished vitrified tile free from all visible defects of size 1500 X 750 mm (thickness to be specified by manufacturer) matching shade of existing/laid tiles.	Sft	400		

10	Providing and laying of already available vitrified tiles along with its grouting laid with chemical or cement mortar.	Sft	300		
11	P/I of Ceramic Tiles				
a)	300X300 mm floor tiles.The tiles shall be approved by the bank before laying.	Sft	0		
b)	300X450 mm wall tiles.The tiles shall be approved by the bank before laying.	Sft	0		
12	P/I of chequered tiles (vitrified exterior tiles) 300mm x 300mm size	Sft	0		
13	Granite works	Sft	286		
14	Providing and doing of Wall Putty	Sft	6438.71		
15	P/F of gyp board ceiling	Sft	2113.11		
16	P/F of low height Partition.	Sft	100		
17	Gyp Finish- P/f of Partition (Partially Solid,Partially Glazed partition	Sft	329.54		
18	P/F of Beeding (3.5 inches wide)	Rft	0		
19	P/F of float glass in doors, windows, partitions, counter separations. Complete job including cost of labour and material.				
a)	12mm Float Glass	Sft	139.75		
b)	8mm Float Glass	Sft	20		
c)	5mm Float Glass	Sft	20		
18	Making and doing itching, moulding etc. of different profiles				
a)	Pencil Moulding	Rft	20		
b)	Grinding	Rft	201		
c)	Bwelling	Rft	33		
20	P/F of Toughened glass in glazed partitions				
a)	12mm thick Glass	Sft	331		
21	P/F of toughened glass for doors	Sft	84		
22	Providing and fixing of Floor Spring Ozone 8400/Ozone 8400(S) with spindle, cover plate, top and bottom patches, pivot and lock, SS Handle -- complete set.	Set	4		
23	P/F of different hardware items of approved brand and specifications:				
a	SS Connectors	No.	20		
b	SS L Patch fitting (Big)	No.	5		
c	SS L Patch fitting (Small)	No.	5		
24	Applying two or more coats of plastic emulsion of approved brand	Sqm	598.39		
25	Painting two or more coats of synthetic enamel	Sqm	95.96		

26	Applying two or more coats of exterior weather proof paint	Sqm	23.23		
27	Sanitary items-Providing & Fixing sanitary items including excavation (if required) and after installing covering it with 1:3:6 concrete and making the things good complete job				
a	CP Angle valve (Basic series, Jaquar, Hindware, Cera or eq)	No.	1		
b	C P Grating	No.	1		
c	Urinal Small (Cera) white	No.	1		
d	PVC Waste Pipe	No.	1		
e	CP waste Coupling	No.	2		
28	P/f of Aluminium Composite Panels (ACP)	Sft	450		
29	P/F of various Aluminium sections in & under ACP on walls, ceiling and frame of doors with necessary screws & dash fasteners but excluding cost of ACP:				
a	2.5" x 1.5" (16 Guage)(Jindal or Eq)	Rft	198		
b	1" x 1.5" (16 Guage)(Jindal or Eq)	Rft	240		
30	P/F of 6 mm thick ply at the back side of ATM partition wall including synthetic enamel paint of approved shade/Brand complete.	Sft	48		
31	Applying Silicon adhesive Band (999) Glue in ACP joints & gap filler.	Rft	124		
32	Structural steel work	Kg	230.02		
B	Stainless Steel Railing grade 304	KG	30		
33	P/f of Front Desks	Rft	26		
34	P/F of cash tellers table	Rft	5		
35	M/S a Unit Head Table of desired dimensions.	Sft	31		
36	M/S a " May I Help You" table	Rft	5		
37	M/S a "Side Credenza"	Sft	17.5		
38	P/F of Partition for cash cabin				
a	Both side Laminate partition (frame + both side ply 12mm + both side 1mm Laminate).	Sft	36.59		
b	Single side Laminate partition (frame + single side ply 12 mm + single side 1mm laminate).	Sft	80		
39	MDF Jaali				
a	Providing & fixing of lattice work in partition as per the approved design made out of MDF Jaali 12 mms thick	Sft	12		
b	Providing & fixing of lattice work in partition as per the approved design made out of MDF Jaali 6 mms thick	Sft	47.58		
40	P/F of storage racks	Sft	0		
41	P/F of storage almirah	Sft	150		

42	Sofa with Arm	Seats	6		
43	P/F of satties	Rft	12		
44	P/f of 2'6"x1'6" writing ledge	No.	1		
45	Providing and fixing of flush door shutters	Sft	87.50		
46	P/f of door frame made out of 18mm/12 plywood and finished with laminate.	Sft	65.25		
47	P/F of CPU Stands made up of 18mm ply	No.	10		
48	P/F of Footrests made of 18mm thk ply	No.	10		
49	Providing Cut holes in tables and glass top and Fixing of PVC/SS Wire managers. Complete job including cost of labour and material.	No.	10		
50	Removal of old wood partition from wall and disposal of the same outside municipal limits or stacking of the usable material at site.	Sft	100		
51	P/F of different hardware items of approved brand and specifications:				
a)	Arl SS 200mm (Godrej or eq)	No.	4		
b)	Handle 6" SS Finish(Godrej or eq)	No.	8		
c)	Cylindrical Lock	No.	1		
d)	Dead Lock Godrej	No.	1		
e)	Tower bolt SS 8"	No.	8		
f)	Tower bolt SS 4"	No.	1		
g)	Door Stopper	No.	4		
h)	Door Closer (Hyper, Godrej or eq)	No.	4		

52	Wiring for lighting point				
	a) Primary point	No	30.00		
	b) loop point from existing primary point	No	25.00		
53	Wiring for Fan point without box	No	2.00		
54	Wiring for Fan point with MS box	No	15.00		
	Wiring for 3 pin 16 A Heating point in 2.5 sqmm				
	a) with less than 11 mtr distance from DB	No	1.00		
55	b) Loop with less than 11 mtr distance from existing point	No	1.00		
	c) with more than 11 mtr distance from DB (<20 mtr)	No	1.00		
	d) with more than 20 mtr distance from DB	No	1.00		
	Wiring for A/C point in 4 sq.mm				
56	a) with less than 11 mtr distance from DB	No	2.00		
	a) with more than 11 mtr distance from DB	No	3.00		
	b) with more than 20 mtr distance from DB	No	2.00		

57	Wiring for UPS/RP point				
	a) 1 No 6A Socket & 1 No. 6A switch from UPS/RP DB	No	3.00		
	b) Loop point of 1 No 6A Socket & 1 No. 6A switch from existing point	No	3.00		
	c) 1 No. 6A socket, 1 No 16A Socket & 1 No. 16A switch from UPS DB	No	1.00		
	d) Loop of 1 No. 6A socket, 1 No 16A Socket & 1 No. 16A switch from existing point	No	1.00		
	e) 2 No. 6A socket, & 1 No. 16A switch from UPS DB	No	7.00		
	f) Loop of 2 No. 6A socket, & 1 No. 16A switch from existing point	No	7.00		
	g) 3 No. 6A socket & 1 No. 16A switch from UPS DB	No	3.00		
	h) Loop of 3 No. 6A socket & 1 No. 16A switch from existing point	No	2.00		
	i) 4 No. 6A socket from UPS DB	No	2.00		
	j) Loop 4 No. 6A socket from existing point	No	2.00		
58	Supply & fixing of UPS Input Output point	No	2.00		
59	Providing & fixing of PVC insulated copper wire				
	a) 1.5 sq mm	Mtr	250.00		
	b) 2.5 sq mm	Mtr	300.00		
	c) 4.0 sq mm	Mtr	100.00		
	d) 6.0 sq mm	Mtr	100.00		
	e) 10.0 sq mm	Mtr	100.00		
60	Providing and fixing of armored Aluminum Cable	Mtr	40.00		
61	Supply, Laying & fixing of Cat 6 Data Cable	Mtr	640.00		
62	Supply, laying & fixing of 2 pair Telephone copper wire	Mtr	360.00		
63	Supply & Laying of PVC Conduit	Mtr	250.00		
64	Supplying, installation, testing and laying of 8 SWG bare Copper wire for Earthing	Mtr	20.00		
65	Providing, fixing, installation, commissioning & testing of 1' x 1' 24 watt LED Square recess lighting fixture	No	28.00		
66	Providing, fixing, installation, commissioning & testing of 15 Watt LED Recess Round lighting fixtures	No	20.00		
67	Providing, fixing, installation, commissioning & testing of lighting fixtures 4 Feet LED Batten	No	4.00		
68	Providing, fixing, installation, commissioning & testing of 2 feet LED Batten	No	2.00		
69	SITC of 400 mm wall fan	No	10.00		

70	SITC of 300 mm Cabin fan	No	1.00		
71	SITC of 150 mm Exhaust fan	No	3.00		
72	SITC of 300 mm Exhaust fan	No	1.00		
73	SITC of networking data jacks	No	20.00		
74	SITC of Telephone jacks	No	12.00		
75	SITC of following items for Rack				
	a) 12 U Networking Rack	No.	1.00		
	b) 24 port Fully Loaded Patch Panel	No.	1.00		
	c) Patch Cords				
	i) 1 Meters	No	30.00		
	ii) 2 Meters	No	2.00		
76	SITC of 4 way double Door (TPN) DB	No	2.00		
77	SITC of 6 way double Door (TPN) DB	No	1.00		
78	SITC of 12 way double Door (SPN) DB	No	1.00		
79	Supply & fixing of MCCB/ MCB as per detail:-				
	a) MCCB TPN 100A 10KA	No	1.00		
	b) MCCB TP 100A 10KA	No	1.00		
	c) MCB FP 40A-63A, 10KA C curve	No	2.00		
	d) MCB FP 6A-32A, 10KA C curve	No	4.00		
	e) MCB DP 40 - 63A C curve	No	2.00		
	f) MCB DP 6 - 32A C curve	No	13.00		
	g) MCB SP 6 - 32A C curve	No	42.00		
80	Rate for fabrication, supply, installation, testing and commissioning of compact cubical indoor type dust proof sheet steel powder coated LT switchgear panel Size:- 3'x3'x1'	cuft	9.00		
81	Providing & fixing of 100A FP Changeover	No	1.00		
82	Supply & fixing of Voltmeter/Ammeter three phase digital type	No	1.00		
83	Supply & fixing of indicator in panel	No	3.00		
84	Supply & fixing of thimbles				
	a) Cu/Aluminum thimbles (2.5/4/6sqmm)	No	150.00		
	b) 50 sqmm Aluminum thimbles	No	8.00		
85	Supply & fixing of 3 pin 6A top	No	4.00		
86	Supply & fixing of 3 pin 16A top	No	2.00		
87	Supply & fixing of ferule	No	200.00		
88	Supply & fixing of 63A Connector	No	2.00		

89	Supply & fixing of ceiling rose with PVC block	No	4.00		
90	Supplying, installation, testing and commissioning of Hooter point in 2 x 1.5 sqmm PVC insulated FR multistrand copper wire through PVC conduit of 25 mm dia and 2 mm thickness	No	1.00		
91	Supply, installation, testing and commissioning of 4 zone intrusion panel including 12 V battery capable of providing backup of 24 hrs. with key operations, LED indicators, capable to connect with high voltage siren & in built digital communicator for i) CMS connectivity through LAN & Telephone ii) Micro controller based inbuilt speech auto dialer	No	1.00		
92	Supply, installation, testing and commissioning of Hand operated Panic switch for security alarm system	No	6.00		
93	Supply, installation, testing and commissioning of Magnetic contacts (heavy duty metal contacts) for security alarm system	No	2.00		
94	Supply, installation, testing and commissioning of PIR motion sensor for security alarm system	No	2.00		
95	Supply, installation, testing and commissioning of Beacon lights for security alarm system	No	2.00		
96	Supply, installation, testing and commissioning of Hooter for security alarm system	No	2.00		
97	SITC of Chemical Earthing station(s)	No	3.00		
98	Supply, installation, testing and commissioning of smoke detectors	No	17.00		
99	Supply, installation, testing and commissioning of heat detectors	No	1.00		
100	Supply, installation, testing and commissioning of main control panel with battery back up of 16 hrs. with 2No. 12V battery (2 Zone)	No	1.00		
101	Supply, installation, testing and commissioning of strobes/Horns	No	2.00		
102	Supply, installation, testing & commissioning of manual call Point	No	2.00		
103	Providing and fixing of Response Indicator	No	3.00		
Total Amount for items above(Rs.)					
Discount if Any %					
Add GST @ 18%					
Grand total including GST (Rs.)					

